

USO	TRAMA	ORDENANZA	PARCELA	SUPERFICIE M2	%	SUP. MAX. CONS. M2	EDIF. M ² /M2	N. DE VIV.	DESTINO
RESIDENCIAL	VIVIENDA UNIFAMILIAR	UAS-3	1	500	0.285	175	0.35	1	PRIVADO
			2	607	0.346	212	0.35	1	PRIVADO
			3	613	0.413	175	0.35	1	PRIVADO
			4	864	0.495	302	0.35	1	PRIVADO
			5	687	0.393	240	0.35	1	PRIVADO
			6	561	0.319	196	0.35	1	PRIVADO
			7	550	0.313	182	0.35	1	PRIVADO
			8	558	0.313	182	0.35	1	PRIVADO
			9	550	0.313	182	0.35	1	PRIVADO
			10	3.000	1.286	1.000	0.35	4	PRIVADO
			11	1.000	0.468	150	0.15	1	PRIVADO
			12	7.012	4.063	426	0.061	1	PRIVADO
SUMA			16.603		3.502		15		
RESIDENCIAL	VIVIENDA UNIFAMILIAR	UAD-1	1	1.644	0.954	1.024	0.629	8	PRIVADO
			2	2.040	1.185	1.306	0.792	12	PRIVADO
			3	2.613	1.502	2.016	1.293	22	PRIVADO
			4	3.703	2.151	3.072	0.830	24	PRIVADO
			5	2.864	1.663	1.792	0.626	14	PRIVADO
			6	2.514	1.460	2.048	0.814	16	PRIVADO
			7	3.720	2.160	3.072	0.826	24	PRIVADO
			8	3.580	3.241	4.068	0.829	36	PRIVADO
			9	3.948	2.593	3.584	0.908	28	PRIVADO
			10	3.697	2.147	3.328	0.960	28	PRIVADO
			11	3.072	1.784	3.072	1.000	24	PRIVADO
			12	2.048	1.189	2.048	1.000	16	PRIVADO
			13	3.787	2.148	3.584	0.951	28	PRIVADO
			14	3.831	2.225	3.584	0.935	28	PRIVADO
			15	2.816	1.635	2.016	1.000	22	PRIVADO
			16	3.328	1.931	3.328	1.000	28	PRIVADO
			17	3.710	2.155	3.328	0.897	28	PRIVADO
			18	898	1.069	1.152	0.888	2	PRIVADO
			19	778	0.451	258	0.329	2	PRIVADO
SUMA			57.359		50.048		391		
RESIDENCIAL	VIVIENDA UNIFAMILIAR	OA-2	1	8.526	4.952	11.834	1.329		PRIVADO
			2	2.533	1.471	1.225	0.484		PRIVADO
SUMA			11.059		12.559		94		
TOTAL			85.021		66.109		500		

USO	TRAMA	ORDENANZA	PARCELA	SUPERFICIE M2	%	SUP. MAX. CONS. M2	EDIF. M ² /M2	N. DE VIV.	DESTINO
PRIVADO	COMERCIAL	E	1	4.286	2.495	2.747	0.65		PRIVADO
			TOTAL	4.286		2.747			
PUBLICO	DOTACIONES	S.T	1	8.460	4.914				PUBLICO
			2	1.862	1.081				PUBLICO
			3	358	0.488				PUBLICO
TOTAL			11.180						
PUBLICO	DOTACIONES	Z.V	1	178	0.088				PUBLICO
			2	296	0.148				PUBLICO
			3	403	0.234				PUBLICO
			4	593	0.344				PUBLICO
			5	791	0.459				PUBLICO
			6	2.213					PUBLICO
TOTAL			21.826						
RED VIAL	RED VIAL	TOTAL		47.614	27.858				PUBLICO
			TOTAL	47.614					
TOTAL			172.140	100%	68.856		500		
					+ 8.254				

MODIFICACIÓN DEL PROYECTO DE REPARCELACIÓN DEL EXPEDIENTE DE ADAPTACIÓN DEL PLAN PARCIAL DEL SECTOR SUP-B5 (RT) "LAS BIZNAGAS", BENAJARAFE. VELEZ MÁLAGA

PLANO DE: FECHA: ESCALA: PLANO "A"

ZONIFICACIÓN SEGÚN EXPEDIENTE ADAPTACIÓN P.P.O. 05/03/2001 Octubre 2022 1:1000 01

Encarga: EXCMO. AYTO VÉLEZ-MÁLAGA

Arquitecto: PABLO JOSÉ ATIENZA JIMÉNEZ

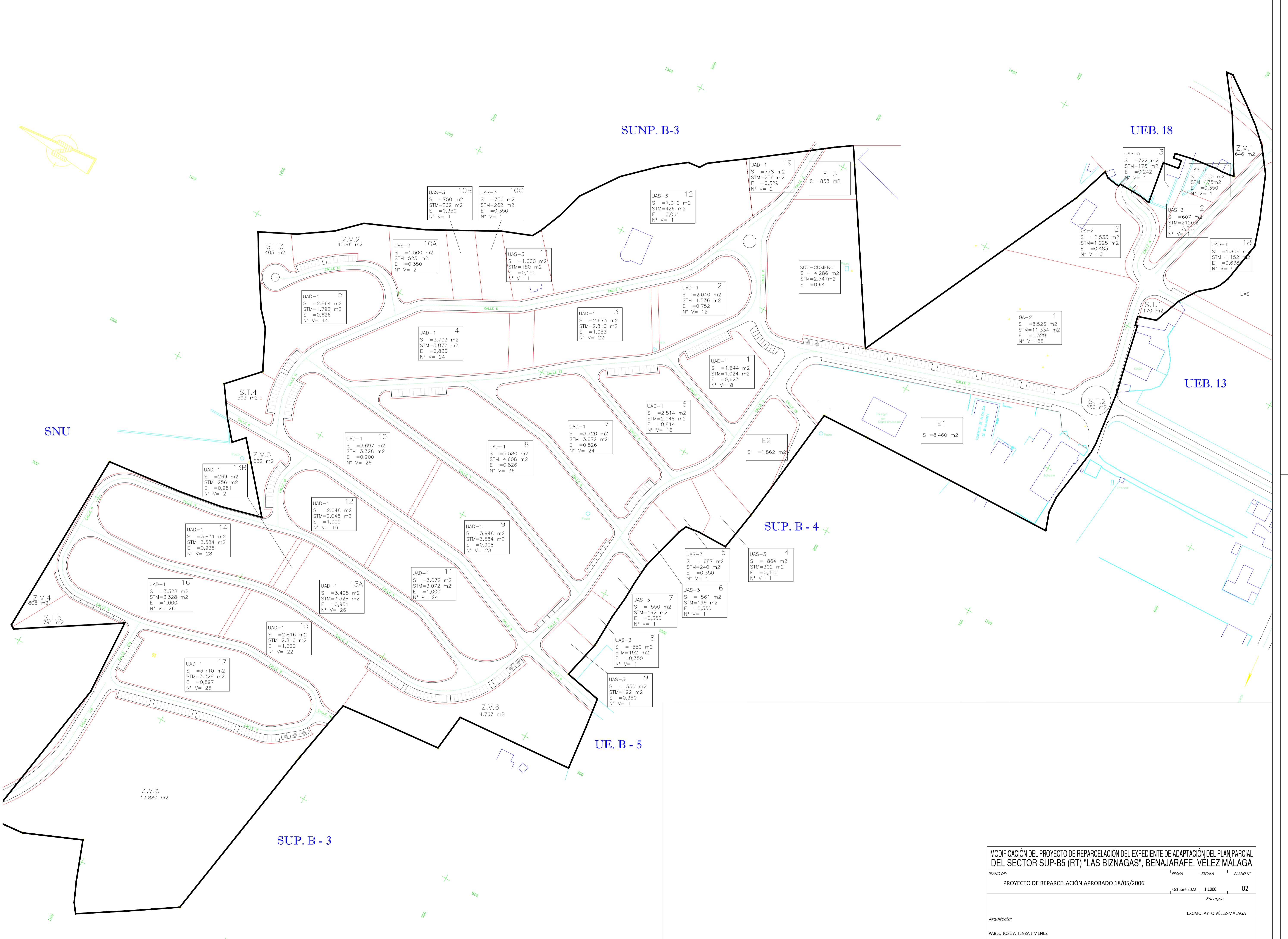

MODIFICACIÓN DEL PROYECTO DE REPARCELACIÓN DEL EXPEDIENTE DE ADAPTACIÓN DEL PLAN PARCIAL DEL SECTOR SUP-B5 (RT) "LAS BIZNAGAS", BENAJARAFE. VÉLEZ MÁLAGA			
PLANO DE:	FECHA:	ESCALA:	PLANO N°:
PROYECTO DE REPARCELACIÓN APROBADO 18/05/2006	Octubre 2022	1:1000	02
Encarga:			
EXCMO. AYTO VÉLEZ-MÁLAGA			
Arquitecto:			
PABLO JOSÉ ATIENZA JIMÉNEZ			

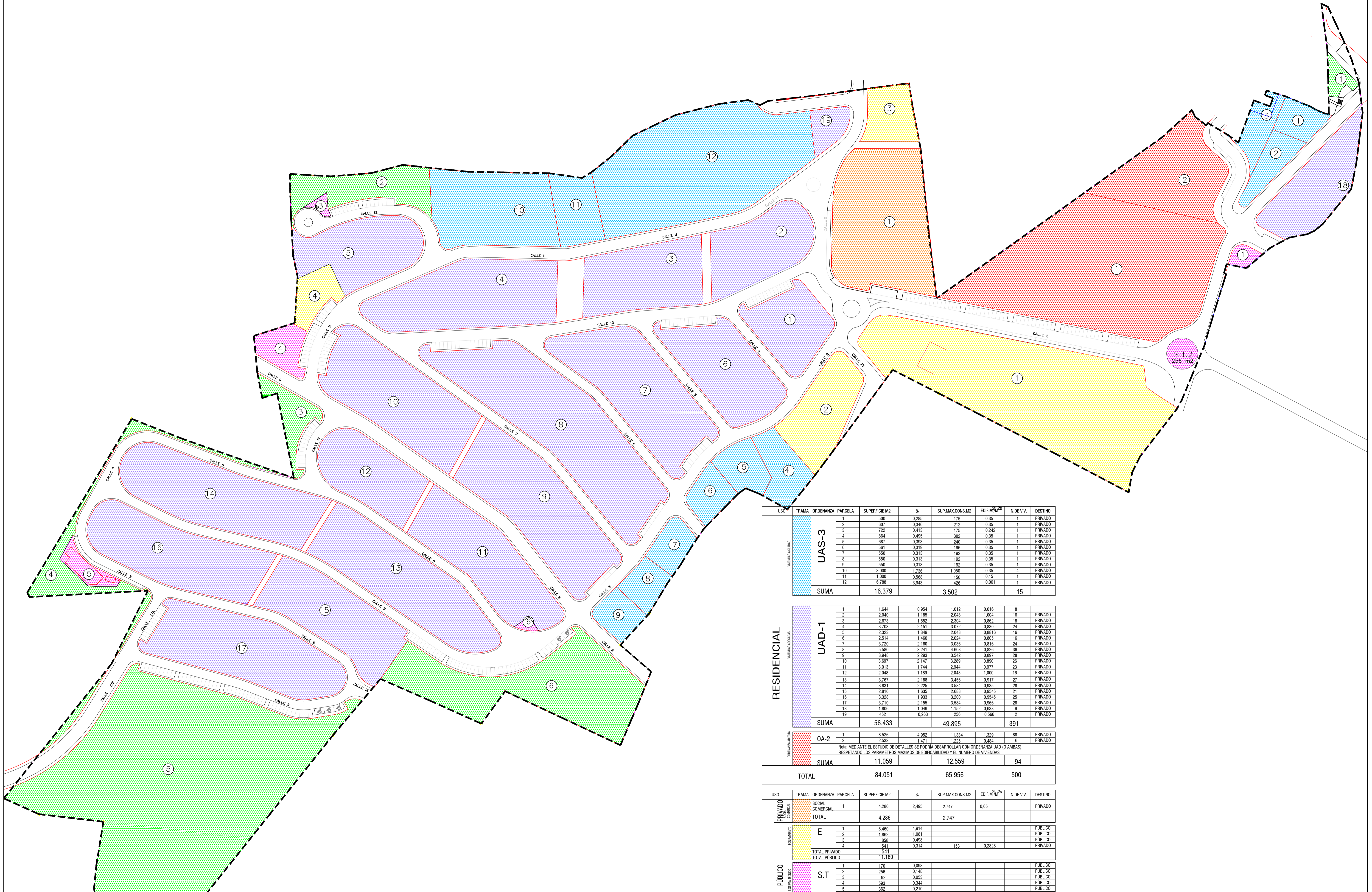

USO	TRAMA	ORDENANZA	PARCELA	SUPERFICIE M2	%	SUP. MAX. CONS. M2	EDIF. M ² /M ² S	N. DE VIV.	DESTINO
RESIDENCIAL	VIVIENDA UNIFAMILIAR	UAS-3	1	500	0,285	175	0,35	1	PRIVADO
			2	667	0,346	212	0,35	1	PRIVADO
			3	722	0,413	175	0,242	1	PRIVADO
			4	864	0,485	302	0,35	1	PRIVADO
			5	687	0,393	240	0,35	1	PRIVADO
			6	561	0,319	198	0,35	1	PRIVADO
			7	550	0,313	192	0,35	1	PRIVADO
			8	550	0,313	192	0,35	1	PRIVADO
			9	550	0,313	192	0,35	1	PRIVADO
			10	3.000	1,736	1.059	0,35	4	PRIVADO
			11	1.000	0,568	150	0,15	1	PRIVADO
			12	6.788	3,943	426	0,061	1	PRIVADO
SUMA			16.379		3.502		15		
RESIDENCIAL	VIVIENDA UNIFAMILIAR	UAD-1	1	1.644	0,954	1.012	0,616	8	PRIVADO
			2	2.040	1,185	2.048	1,004	16	PRIVADO
			3	2.673	1,552	2.304	0,862	18	PRIVADO
			4	3.703	2,151	3.072	0,830	24	PRIVADO
			5	2.323	1,349	2.048	0,8816	16	PRIVADO
			6	2.514	1,460	2.024	0,805	16	PRIVADO
			7	3.720	2,160	3.036	0,816	24	PRIVADO
			8	5.580	3,241	4.608	0,826	36	PRIVADO
			9	3.049	2,293	3.542	0,897	28	PRIVADO
			10	3.697	2,147	3.289	0,890	26	PRIVADO
			11	3.013	1,744	2.944	0,977	23	PRIVADO
			12	2.048	1,169	2.048	1,000	16	PRIVADO
			13	3.767	2,198	3.456	0,917	27	PRIVADO
			14	3.831	2,225	3.594	0,935	28	PRIVADO
			15	2.816	1,635	2.888	0,9545	21	PRIVADO
			16	3.328	1,933	3.200	0,9545	25	PRIVADO
			17	3.710	2,155	3.584	0,966	28	PRIVADO
			18	1.808	1,049	1.152	0,638	9	PRIVADO
			19	452	0,263	256	0,566	2	PRIVADO
SUMA			56.433		49.895		391		
RESIDENCIAL	VIVIENDA UNIFAMILIAR	OA-2	1	8.528	4,852	11.334	1,329	88	PRIVADO
			2	2.533	1,471	1.225	0,484	6	PRIVADO
SUMA			11.059		12.559		94		
TOTAL			84.051		65.956		500		

USO	TRAMA	ORDENANZA	PARCELA	SUPERFICIE M2	%	SUP. MAX. CONS. M2	EDIF. M ² /M ² S	N. DE VIV.	DESTINO
PRIVADO	SOCIOS COMERCIAL	TOTAL	1	4.286	2,495	2.747	0,65		PRIVADO
			TOTAL	4.286		2.747			
PÚBLICO	EDIFICIOS	E	1	8.400	4,914				PÚBLICO
			2	1.882	1,081				PÚBLICO
			3	858	0,498				PÚBLICO
			4	541	0,314	153	0,2828		PÚBLICO
			TOTAL PRIVADO	11.180					
PÚBLICO	ESTR. TIPO	S.T	1	170	0,098				PÚBLICO
			2	256	0,148				PÚBLICO
			3	92	0,053				PÚBLICO
			4	593	0,344				PÚBLICO
			5	382	0,210				PÚBLICO
			6	59	0,034				PÚBLICO
TOTAL			1.532						
PÚBLICO	ZONA VERDE	Z.V	1	235	0,137				PRIVADO
			2	1.497	0,817				PÚBLICO
			3	632	0,367				PÚBLICO
			4	1.234	0,717				PÚBLICO
			5	13.860	0,802				PÚBLICO
			6	4.767	2,769				PÚBLICO
TOTAL PRIVADO			235						
TOTAL PÚBLICO			21.920						
PÚBLICO	RED VARIAS	TOTAL	1	48.395	28,113				PÚBLICO
			TOTAL	48.395					
TOTAL			172.140	100%	68.856		500		
					+ 8.254				

MODIFICACIÓN DEL PROYECTO DE REPARCELACIÓN DEL EXPEDIENTE DE ADAPTACIÓN DEL PLAN PARCIAL DEL SECTOR SUP-B5 (RT) "LAS BIZNAGAS", BENAJARAFE. VELEZ MALAGA

PLANO DE: ZONIFICACIÓN CONFORME A LA MODIFICACIÓN APROBADA AÑO 2017

FECHA: Octubre 2022 | ESCALA: 1:1000 | PLANO N°: 03

Encargo: EXCMO. AYTO VÉLEZ-MÁLAGA

Arquitecto: PABLO JOSÉ ATIENZA JIMÉNEZ



APROPIABLE PARCELA 19

1	X=393211.98 Y=4064453.69
2	X=393218.54 Y=4064443.83
3	X=393222.95 Y=4064437.19
4	X=393223.27 Y=4064435.50
5	X=393223.03 Y=4064434.00
6	X=393222.32 Y=4064432.66
7	X=393220.51 Y=4064431.19
8	X=393218.18 Y=4064430.17
9	X=393216.66 Y=4064429.90
10	X=393213.42 Y=4064429.50
11	X=393210.28 Y=4064429.56
12	X=393207.00 Y=4064430.09
13	X=393202.42 Y=4064431.92
14	X=393198.01 Y=4064434.14
15	X=393189.66 Y=4064438.31
16	X=393202.85 Y=4064447.13

SUPERFICIE APROPIABLE PARCELA 19 = 452 m²

SUPERFICIE PARCELA 19 = 479,27 m²

SERVIDUMBRE PARCELA 19

3	X=393222.95 Y=4064437.19
4	X=393223.27 Y=4064435.50
5	X=393223.03 Y=4064434.00
6	X=393222.32 Y=4064432.66
7	X=393220.51 Y=4064431.19
8	X=393218.18 Y=4064430.17
9	X=393216.66 Y=4064429.90
10	X=393213.42 Y=4064429.50
11	X=393210.28 Y=4064429.56
12	X=393207.00 Y=4064430.09
13	X=393202.42 Y=4064431.92
14	X=393198.01 Y=4064434.14
15	X=393189.66 Y=4064438.31
17	X=393188.90 Y=4064437.81
18	X=393200.69 Y=4064431.96
19	X=393203.80 Y=4064430.48
20	X=393206.73 Y=4064429.33
21	X=393209.91 Y=4064428.85
22	X=393211.65 Y=4064428.80
23	X=393216.38 Y=4064429.05
24	X=393220.56 Y=4064430.29
25	X=393221.83 Y=4064431.18
26	X=393223.40 Y=4064433.43
27	X=393223.59 Y=4064435.13

SUPERFICIE SERVIDUMBRE PARCELA 19 = 27,27 m²

MODIFICACIÓN DEL PROYECTO DE REPARCELACIÓN DEL EXPEDIENTE DE ADAPTACIÓN DEL PLAN PARCIAL DEL SECTOR SUP-B5 (RT) "LAS BIZNAGAS", BENAJARAFE. VÉLEZ MÁLAGA			
PLANO DE:	FECHA	ESCALA	PLANO N°
DELIMITACIÓN PARCELA UAD1-19	Octubre 2022	1 : 200	04
Encargado:			
EXCMO. AYTO VÉLEZ-MÁLAGA			
Arquitecto:			
PABLO JOSÉ ATIENZA JIMÉNEZ			



PARCELA UAS-3 12

1	X=393124.69	Y=4064549.00
2	X=393126.42	Y=4064546.80
3	X=393137.67	Y=4064541.09
4	X=393146.32	Y=4064538.22
5	X=393153.04	Y=4064536.72
6	X=393159.18	Y=4064533.71
7	X=393166.68	Y=4064527.98
8	X=393176.93	Y=4064517.22
9	X=393189.88	Y=4064502.33
10	X=393200.29	Y=4064485.80
11	X=393201.03	Y=4064484.08
12	X=393201.09	Y=4064482.22
13	X=393200.35	Y=4064477.52
14	X=393200.47	Y=4064473.06
15	X=393202.18	Y=4064468.93
16	X=393211.98	Y=4064453.69
17	X=393202.85	Y=4064447.13
18	X=393192.39	Y=4064440.14
19	X=393188.90	Y=4064437.81
20	X=393164.86	Y=4064450.08
21	X=393155.30	Y=4064455.19
22	X=393149.76	Y=4064458.26
23	X=393145.37	Y=4064461.36
24	X=393140.70	Y=4064465.94
25	X=393134.69	Y=4064473.25
26	X=393118.64	Y=4064494.20
27	X=393094.59	Y=4064526.03

SUPERFICIE PARCELA UAS-3 12 = 6.459,89 m²

MODIFICACIÓN DEL PROYECTO DE REPARCELACIÓN DEL EXPEDIENTE DE ADAPTACIÓN DEL PLAN PARCIAL DEL SECTOR SUP-B5 (RT) "LAS BIZNAGAS", BENAJARAFE. VÉLEZ MÁLAGA

PLANO DE:	FECHA:	ESCALA:	PLANO N°:
DELIMITACIÓN PARCELA UAS 3-12	Octubre 2022	1 : 250	05

Encargado: EXCMO. AYTO VÉLEZ-MÁLAGA

Arquitecto: PABLO JOSÉ ATIENZA JIMÉNEZ

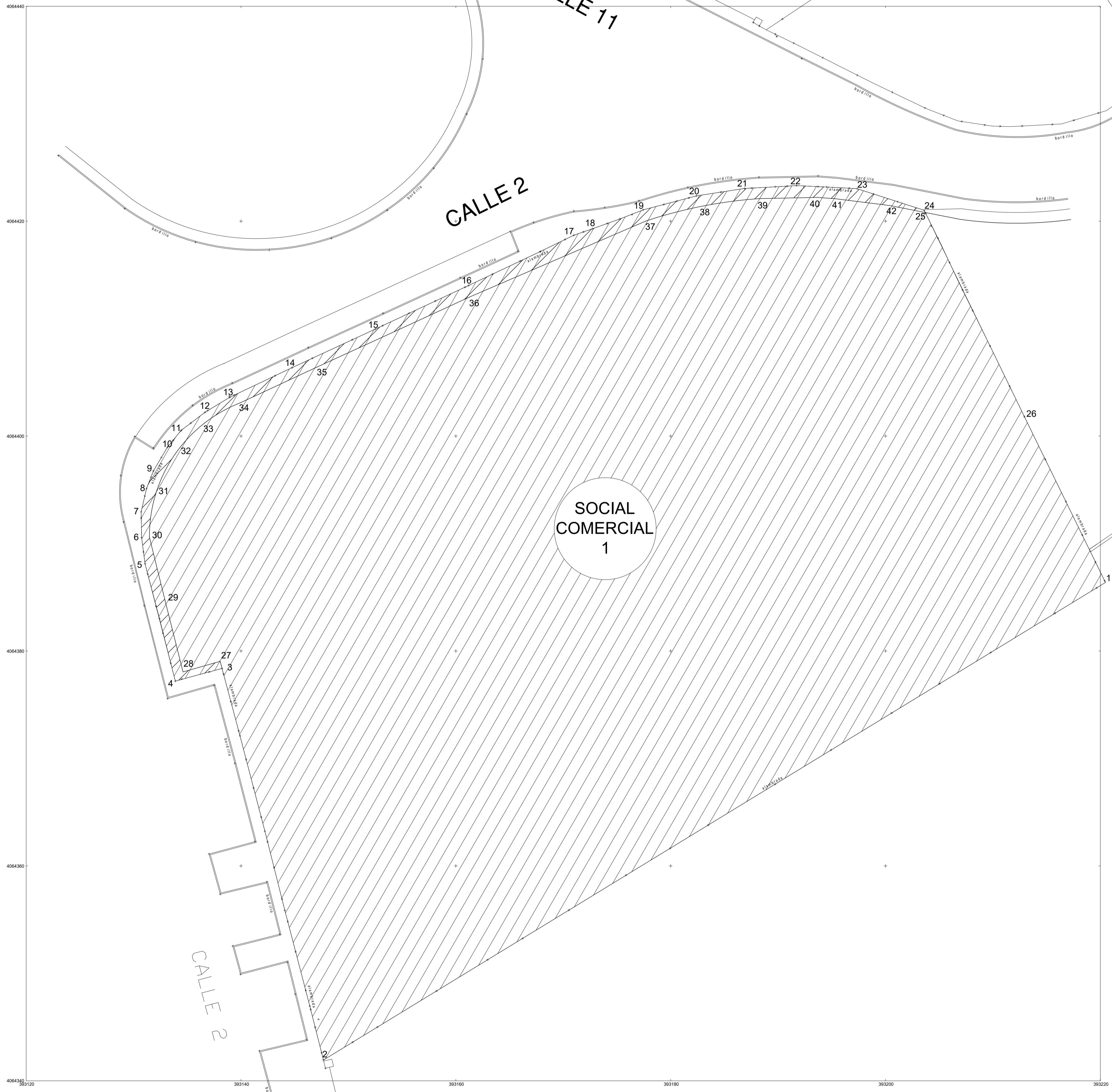

PARCELA SOCIAL COMERCIAL

1	X=393220.48 Y=4064386.38
2	X=393147.67 Y=4064341.93
3	X=393138.23 Y=4064378.38
4	X=393133.89 Y=4064377.20
5	X=393131.07 Y=4064388.12
6	X=393130.75 Y=4064390.56
7	X=393130.70 Y=4064392.94
8	X=393131.20 Y=4064395.11
9	X=393131.85 Y=4064396.75
10	X=393133.15 Y=4064398.97
11	X=393134.43 Y=4064400.53
12	X=393136.89 Y=4064402.37
13	X=393138.95 Y=4064403.61
14	X=393144.76 Y=4064406.37
15	X=393152.50 Y=4064409.96
16	X=393161.19 Y=4064414.01
17	X=393170.98 Y=4064418.69
18	X=393172.75 Y=4064419.30
19	X=393177.44 Y=4064421.05
20	X=393182.40 Y=4064422.35
21	X=393186.88 Y=4064423.04
22	X=393191.71 Y=4064423.31
23	X=393197.34 Y=4064423.02
24	X=393203.60 Y=4064421.02
25	X=393203.70 Y=4064420.81
26	X=393212.93 Y=4064401.82

SERVIDUMBRE PARCELA

3	X=393138.23 Y=4064378.38
4	X=393133.89 Y=4064377.20
5	X=393131.07 Y=4064388.12
6	X=393130.75 Y=4064390.56
7	X=393130.70 Y=4064392.94
8	X=393131.20 Y=4064395.11
9	X=393131.85 Y=4064396.75
10	X=393133.15 Y=4064398.97
11	X=393134.43 Y=4064400.53
12	X=393136.89 Y=4064402.37
13	X=393138.95 Y=4064403.61
14	X=393144.76 Y=4064406.37
15	X=393152.50 Y=4064409.96
16	X=393161.19 Y=4064414.01
17	X=393170.98 Y=4064418.69
18	X=393172.75 Y=4064419.30
19	X=393177.44 Y=4064421.05
20	X=393182.40 Y=4064422.35
21	X=393186.88 Y=4064423.04
22	X=393191.71 Y=4064423.31
23	X=393197.34 Y=4064423.02
24	X=393203.60 Y=4064421.02
25	X=393203.70 Y=4064420.81
26	X=393212.93 Y=4064401.82
27	X=393138.06 Y=4064379.04
28	X=393134.60 Y=4064378.05
29	X=393132.93 Y=4064384.69
30	X=393131.48 Y=4064390.56
31	X=393132.16 Y=4064394.93
32	X=393134.34 Y=4064398.96
33	X=393136.54 Y=4064401.16
34	X=393139.90 Y=4064403.08
35	X=393147.07 Y=4064406.25
36	X=393161.24 Y=4064412.93
37	X=393177.67 Y=4064420.01
38	X=393182.92 Y=4064421.39
39	X=393188.31 Y=4064422.10
40	X=393193.67 Y=4064422.21
41	X=393195.32 Y=4064422.09
42	X=393200.39 Y=4064421.46
43	X=393203.70 Y=4064420.81

SUPERFICIE PARCELA
4.270,33 m²

SUPERFICIE APROPIABLE PARCELA
4.172,15 m²

SUPERFICIE SERVIDUMBRE PARCELA
98,18 m²

MODIFICACIÓN DEL PROYECTO DE REPARCELACIÓN DEL EXPEDIENTE DE ADAPTACIÓN DEL PLAN PARCIAL DEL SECTOR SUP-B5 (RT) "LAS BIZNAGAS", BENAJARAFE. VÉLEZ MÁLAGA

PLANO DE:	FECHA:	ESCALA:	PLANO N°:
DELIMITACIÓN PARCELA SOCIAL COMERCIAL 1	Octubre 2022	1 : 200	06

Encargado: EXCMO. AYTO VÉLEZ-MÁLAGA

Arquitecto: PABLO JOSÉ ATIENZA JIMÉNEZ

PARCELA EQUIPAMIENTO 3

1	X=393236.94 Y=4064429.93
2	X=393237.44 Y=4064429.06
3	X=393240.95 Y=4064423.18
4	X=393245.09 Y=4064416.47
5	X=393249.01 Y=4064410.13
6	X=393223.64 Y=4064388.98
7	X=393215.88 Y=4064405.00
8	X=393208.64 Y=4064419.97
9	X=393208.12 Y=4064421.03
10	X=393212.64 Y=4064420.81
11	X=393217.15 Y=4064421.15
12	X=393221.94 Y=4064422.49
13	X=393226.48 Y=4064424.51

SUPERFICIE PARCELA EQUIPAMIENTO 3 = 858,00 m²

SUPERFICIE APROPIABLE PARCELA = 827,22 m²

E-3

SERVIDUMBRE

8	X=393208.64 Y=4064419.97
9	X=393208.12 Y=4064421.03
10	X=393212.64 Y=4064420.81
11	X=393217.15 Y=4064421.15
12	X=393221.94 Y=4064422.49
13	X=393226.48 Y=4064424.51
1	X=393236.94 Y=4064429.93
2	X=393237.44 Y=4064429.06
14	X=393226.95 Y=4064423.62
15	X=393222.26 Y=4064421.54
16	X=393217.32 Y=4064420.16
17	X=393212.98 Y=4064419.82

SUPERFICIE SERVIDUMBRE = 30,78 m²

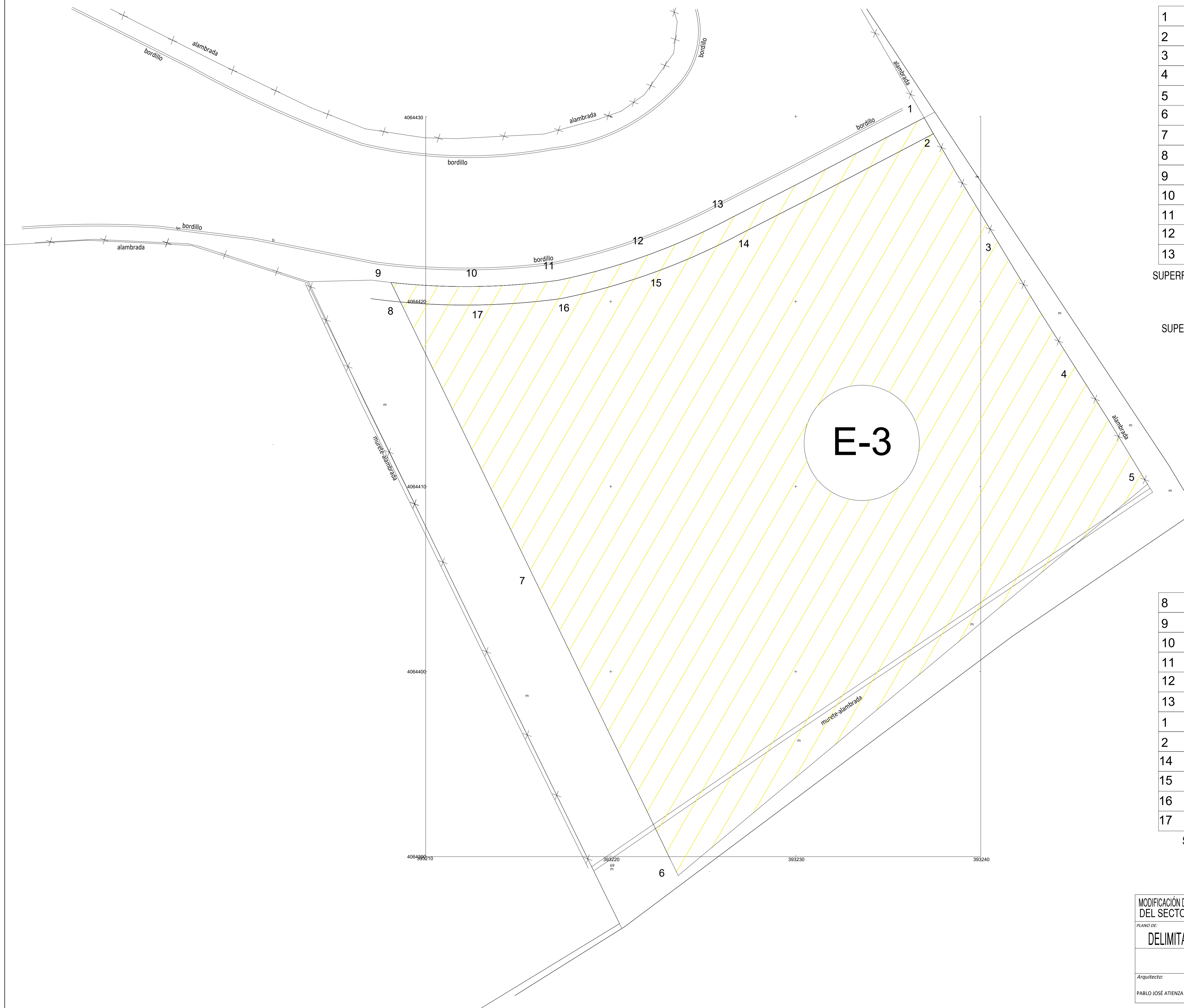

MODIFICACIÓN DEL PROYECTO DE REPARCELACIÓN DEL EXPEDIENTE DE ADAPTACIÓN DEL PLAN PARCIAL DEL SECTOR SUP-B5 (RT) "LAS BIZNAGAS", BENAJARAFE. VÉLEZ MÁLAGA			
PLANO DE:	FECHA	ESCALA	PLANO N°
DELIMITACIÓN PARCELA EQUIPAMIENTO E-3	Octubre 2022	1 : 100	07
Encargado:			
EXCMO. AYTO VÉLEZ-MÁLAGA			
Arquitecto:			
PABLO JOSÉ ATIENZA JIMÉNEZ			



ZONA VERDE 2

1	X=393048.92 Y=4064705.48
2	X=393057.54 Y=4064684.73
3	X=393069.46 Y=4064664.60
4	X=393081.59 Y=4064650.46
5	X=393086.81 Y=4064636.04
6	X=393059.68 Y=4064620.93
7	X=393060.61 Y=4064622.69
8	X=393062.07 Y=4064626.77
9	X=393062.77 Y=4064631.04
10	X=393062.53 Y=4064637.01
11	X=393060.59 Y=4064642.66
12	X=393059.95 Y=4064644.03
13	X=393064.07 Y=4064645.95
14	X=393061.38 Y=4064651.20
15	X=393059.69 Y=4064654.09
16	X=393058.00 Y=4064656.97
17	X=393055.61 Y=4064660.55
18	X=393053.22 Y=4064664.13
19	X=393049.83 Y=4064668.21
20	X=393046.44 Y=4064672.30
21	X=393043.44 Y=4064675.29
22	X=393040.44 Y=4064678.29
23	X=393048.03 Y=4064682.86
24	X=393033.73 Y=4064691.94
25	X=393029.70 Y=4064693.40
26	X=393025.04 Y=4064692.48
27	X=393036.45 Y=4064698.70

SUPERFICIE ZONA VERDE 2 = 1407,00 M2

SISTEMA TÉCNICO 3

22	X=393040.44 Y=4064678.29
28	X=393037.17 Y=4064675.08
29	X=393036.22 Y=4064676.60
30	X=393036.22 Y=4064678.38
31	X=393036.73 Y=4064680.41
32	X=393037.39 Y=4064682.40
33	X=393037.64 Y=4064683.97
34	X=393037.40 Y=4064686.70
35	X=393036.06 Y=4064689.66
24	X=393033.73 Y=4064691.94
23	X=393048.03 Y=4064682.86

SUPERFICIE SISTEMA TÉCNICO 3 = 79,73 m²

MODIFICACIÓN DEL PROYECTO DE REPARCELACIÓN DEL EXPEDIENTE DE ADAPTACIÓN DEL PLAN PARCIAL DEL SECTOR SUP-B5 (RT) "LAS BIZNAGAS", BENAJARAFE. VÉLEZ MÁLAGA

PLANO DE:	FECHA:	ESCALA:	PLANO N°:
DELIMITACIÓN PARCELAS ZV-2 Y ST-3	Octubre 2022	1 : 200	08
Encarga:			
EXCMO. AYTO VÉLEZ-MÁLAGA			
Arquitecto:			
PABLO JOSÉ ATIENZA JIMÉNEZ			

ZONA VERDE 4

ZONA VERDE 4

1	X=392765.21 Y=4064737.03
2	X=392823.41 Y=4064731.89
3	X=392852.51 Y=4064729.33
4	X=392863.89 Y=4064728.34
5	X=392881.61 Y=4064726.76
6	X=392884.11 Y=4064694.90
7	X=392887.49 Y=4064665.72
8	X=392890.87 Y=4064636.54
9	X=392887.34 Y=4064654.95
10	X=392884.58 Y=4064683.35
11	X=392882.41 Y=4064706.79
12	X=392880.99 Y=4064713.13
13	X=392879.11 Y=4064716.91
14	X=392876.38 Y=4064720.70
15	X=392873.07 Y=4064723.73
16	X=392867.85 Y=4064726.80
17	X=392862.83 Y=4064728.12
18	X=392845.49 Y=4064729.19
19	X=392845.49 Y=4064729.34
20	X=392830.11 Y=4064730.25
21	X=392824.09 Y=4064730.28
22	X=392816.58 Y=4064728.73
23	X=392812.55 Y=4064726.90
24	X=392809.11 Y=4064724.73
25	X=392807.75 Y=4064726.20
26	X=392792.65 Y=4064725.16
27	X=392785.14 Y=4064703.71
28	X=392791.13 Y=4064687.15
29	X=392796.24 Y=4064686.80
30	X=392796.19 Y=4064675.81
31	X=392780.07 Y=4064704.87
32	X=392763.48 Y=4064734.76

43	X=392796.23 Y=4064674.98
44	X=392796.43 Y=4064670.31
45	X=392792.14 Y=4064671.35
46	X=392767.17 Y=4064673.92
47	X=392758.37 Y=4064674.42
48	X=392754.00 Y=4064674.46
49	X=392747.02 Y=4064674.37
50	X=392738.63 Y=4064674.77
51	X=392729.43 Y=4064675.76
52	X=392719.35 Y=4064677.73
53	X=392712.96 Y=4064679.51
54	X=392703.35 Y=4064682.69
55	X=392691.46 Y=4064687.89
56	X=392689.45 Y=4064688.92
57	X=392706.49 Y=4064683.28
58	X=392723.50 Y=4064677.64
59	X=392745.87 Y=4064675.41
60	X=392773.10 Y=4064675.17

SUPERFICIE ZONA VERDE 4 = 1234,00 M2

SISTEMA TECNICO 5

25	X=392807.75 Y=4064726.20
26	X=392792.65 Y=4064725.16
27	X=392785.14 Y=4064703.71
28	X=392791.13 Y=4064687.15
29	X=392796.24 Y=4064686.80
33	X=392796.21 Y=4064694.02
34	X=392794.65 Y=4064694.03
35	X=392794.38 Y=4064695.12
36	X=392794.21 Y=4064695.08
37	X=392794.24 Y=4064697.65
38	X=392794.55 Y=4064700.43
39	X=392794.91 Y=4064702.31
40	X=392798.72 Y=4064713.00
41	X=392801.68 Y=4064718.87
42	X=392804.55 Y=4064722.95

SUPERFICIE SISTEMA TECNICO 5 = 362 M2



MODIFICACIÓN DEL PROYECTO DE REPARCELACIÓN DEL EXPEDIENTE DE ADAPTACIÓN DEL PLAN PARCIAL DEL SECTOR SUP-B5 (RT) "LAS BIZNAGAS", BENAJARAFE. VÉLEZ MÁLAGA

PLANO DE:	FECHA:	ESCALA:	PLANO N°:
DELIMITACIÓN PARCELAS ZV-5 Y ST-4	Octubre 2022	1 : 400	09
Encargado:			
EXCMO. AYTO VÉLEZ-MÁLAGA			
Arquitecto:			
PABLO JOSÉ ATIENZA JIMÉNEZ			



ZONA VERDE 1

1	X=393373.90 Y=4064200.09
2	X=393365.44 Y=4064177.21
3	X=393364.11 Y=4064176.61
4	X=393360.01 Y=4064177.96
5	X=393361.28 Y=4064181.79
6	X=393353.25 Y=4064182.25
7	X=393351.27 Y=4064188.31
8	X=393367.61 Y=4064196.77

SUPERFICIE ZONA VERDE 1 = 235.00 M2

MODIFICACIÓN DEL PROYECTO DE REPARCELACIÓN DEL EXPEDIENTE DE ADAPTACIÓN DEL PLAN PARCIAL DEL SECTOR SUP-B5 (RT) "LAS BIZNAGAS", BENAJARAFE. VÉLEZ MÁLAGA			
PLANO DE:	FECHA	ESCALA	PLANO N°
DELIMITACIÓN PARCELA ZV-1	Octubre 2022	1 : 150	10
Encargado:			
EXCMO. AYTO VÉLEZ-MÁLAGA			
Arquitecto:			
PABLO JOSÉ ATIENZA JIMÉNEZ			



SISTEMA TÉCNICO 6

1	X=392873.28	Y=4064471.59
2	X=392880.07	Y=4064468.25
3	X=392876.50	Y=4064461.02
4	X=392873.48	Y=4064465.89
5	X=392876.77	Y=4064461.22
6	X=392872.47	Y=4064468.05
7	X=392872.15	Y=4064469.77
8	X=392872.44	Y=4064469.81

SUPERFICIE = 42.9252 M2

MODIFICACIÓN DEL PROYECTO DE REPARCELACIÓN DEL EXPEDIENTE DE ADAPTACIÓN DEL PLAN PARCIAL DEL SECTOR SUP-B5 (RT) "LAS BIZNAGAS", BENAJARAFE. VÉLEZ MÁLAGA			
PLANO DE:	FECHA	ESCALA	PLANO N°
DELIMITACIÓN PARCELA ST-6	Octubre 2022	1 : 100	11
Encargado:			
EXCMO. AYTO VÉLEZ-MÁLAGA			
Arquitecto:			
PABLO JOSÉ ATIENZA JIMÉNEZ			

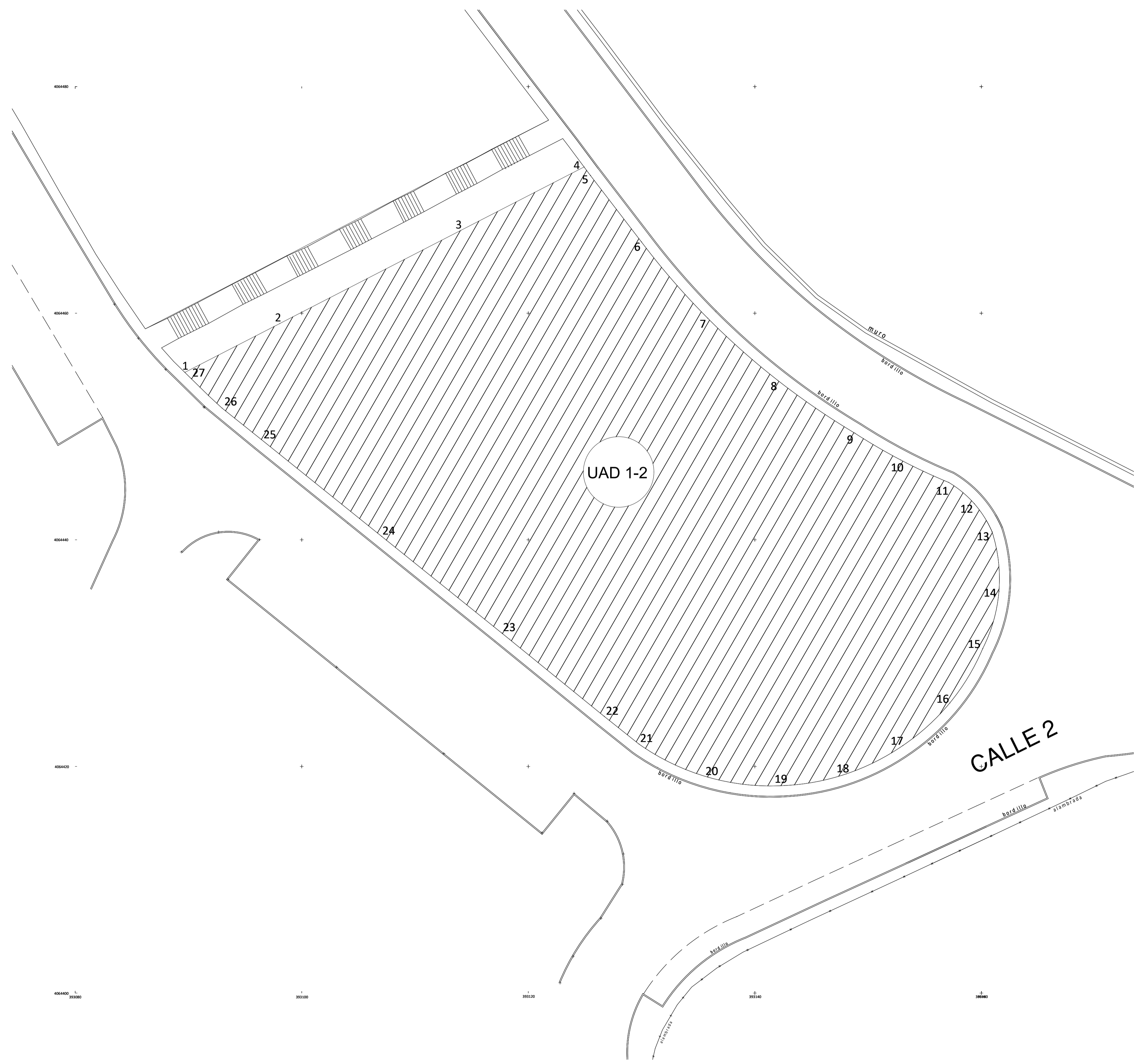

PARCELA 2

1	X=393089.68 Y=4064454.77
2	X=393098.04 Y=4064459.08
3	X=393114.04 Y=4064467.31
4	X=393124.93 Y=4064472.90
5	X=393125.48 Y=4064472.16
6	X=393129.99 Y=4064466.30
7	X=393135.84 Y=4064459.56
8	X=393142.01 Y=4064454.08
9	X=393148.83 Y=4064449.41
10	X=393152.87 Y=4064447.05
11	X=393157.10 Y=4064445.07
12	X=393159.37 Y=4064443.20
13	X=393160.94 Y=4064440.71
14	X=393161.55 Y=4064435.47
15	X=393160.11 Y=4064430.39
16	X=393157.21 Y=4064425.60
17	X=393153.05 Y=4064421.84
18	X=393148.06 Y=4064419.34
19	X=393142.58 Y=4064418.31
20	X=393135.87 Y=4064419.05
21	X=393129.78 Y=4064421.97
22	X=393126.70 Y=4064424.42
23	X=393117.65 Y=4064431.78
24	X=393107.05 Y=4064440.31
25	X=393096.44 Y=4064448.84
26	X=393092.96 Y=4064451.63
27	X=393090.23 Y=4064454.23

SUPERF PARC 2 UAD-1 = 2044,75 M2

MODIFICACIÓN DEL PROYECTO DE REPARCELACIÓN DEL EXPEDIENTE DE ADAPTACIÓN DEL PLAN PARCIAL DEL SECTOR SUP-B5 (RT) "LAS BIZNAGAS", BENAJARAFE. VÉLEZ MÁLAGA

PLANO DE:	FECHA:	ESCALA:	PLANO N°:
DELIMITACIÓN PARCELA UAD 1-2	Octubre 2022	1 : 200	12
Encargado:			
EXCMO. AYTO VÉLEZ-MÁLAGA			
Arquitecto:			
PABLO JOSÉ ATIENZA JIMÉNEZ			

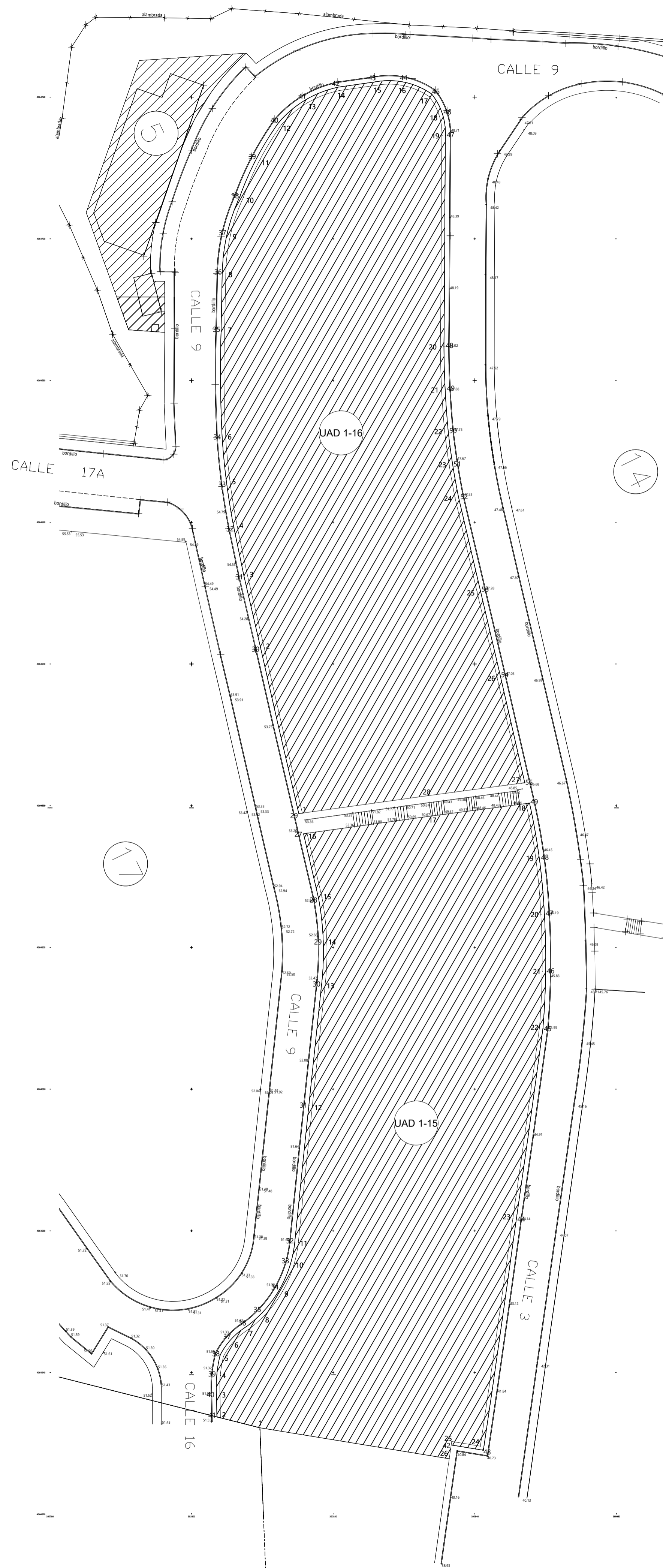

PARCELA 15

1	X=392809.66 Y=4064532.21
2	X=392804.09 Y=4064533.62
3	X=392804.03 Y=4064536.86
4	X=392804.07 Y=4064539.59
5	X=392804.52 Y=4064542.29
6	X=392806.02 Y=4064544.43
7	X=392808.05 Y=4064546.08
8	X=392810.24 Y=4064548.00
9	X=392812.86 Y=4064551.47
10	X=392814.51 Y=4064555.36
11	X=392815.08 Y=4064558.35
12	X=392817.07 Y=4064577.64
13	X=392818.87 Y=4064594.73
14	X=392819.11 Y=4064600.93
15	X=392818.42 Y=4064607.09
16	X=392816.32 Y=4064616.11
17	X=392833.84 Y=4064618.55
18	X=392847.23 Y=4064620.30
19	X=392848.61 Y=4064612.52
20	X=392849.32 Y=4064604.66
21	X=392849.51 Y=4064596.64
22	X=392849.12 Y=4064588.63
23	X=392845.37 Y=4064561.72
24	X=392840.79 Y=4064529.61
25	X=392836.74 Y=4064530.28
26	X=392836.39 Y=4064527.84

SUPERFICIE APROPIABLE PARCELA 15
2.805,13 M2

SUPERFICIE PARCELA 15
2.896,53 M2

SERVIDUMBRE PARCELA 15 (CALLE 9)

2	X=392804.09 Y=4064533.62
3	X=392804.03 Y=4064536.86
4	X=392804.07 Y=4064539.59
5	X=392804.52 Y=4064542.29
6	X=392806.02 Y=4064544.43
7	X=392808.05 Y=4064546.08
8	X=392810.24 Y=4064548.00
9	X=392812.86 Y=4064551.47
10	X=392814.51 Y=4064555.36
11	X=392815.08 Y=4064558.35
12	X=392817.07 Y=4064577.64
13	X=392818.87 Y=4064594.73
14	X=392819.11 Y=4064600.93
15	X=392818.42 Y=4064607.09
16	X=392816.32 Y=4064616.11
27	X=392815.82 Y=4064616.04
28	X=392817.93 Y=4064606.99
29	X=392818.61 Y=4064600.90
30	X=392818.37 Y=4064594.79
31	X=392816.57 Y=4064577.69
32	X=392814.59 Y=4064558.40
33	X=392814.00 Y=4064555.43
34	X=392812.43 Y=4064551.73
35	X=392809.95 Y=4064548.41
36	X=392807.77 Y=4064546.50
37	X=392805.63 Y=4064544.74
38	X=392804.05 Y=4064542.46
39	X=392803.57 Y=4064539.67
40	X=392803.53 Y=4064536.84
41	X=392803.59 Y=4064533.74

SERVIDUMBRE PARCELA 15 (C9)
43,34 M2

SERVIDUMBRE PARCELA 15 (CALLE 3)

18	X=392847.23 Y=4064620.30
19	X=392848.61 Y=4064612.52
20	X=392849.32 Y=4064604.66
21	X=392849.51 Y=4064596.64
22	X=392849.12 Y=4064588.63
23	X=392845.37 Y=4064561.72
24	X=392840.79 Y=4064529.61
25	X=392836.74 Y=4064530.28
42	X=392836.67 Y=4064529.78
43	X=392841.21 Y=4064529.04
44	X=392845.86 Y=4064561.65
45	X=392849.62 Y=4064588.57
46	X=392850.01 Y=4064596.62
47	X=392849.82 Y=4064604.68
48	X=392849.11 Y=4064612.57
49	X=392847.73 Y=4064620.37

SERVIDUMBRE PARCELA 15 (C3)
48,06 M2

PARCELA 16

1	X=392815.65 Y=4064618.95
2	X=392810.26 Y=4064642.36
3	X=392807.89 Y=4064652.57
4	X=392806.47 Y=4064659.39
5	X=392805.44 Y=4064665.70
6	X=392804.83 Y=4064672.07
7	X=392804.69 Y=4064687.26
8	X=392804.84 Y=4064695.07
9	X=392805.51 Y=4064700.57
10	X=392807.31 Y=4064705.81
11	X=392809.66 Y=4064711.16
12	X=392812.74 Y=4064716.14
13	X=392816.40 Y=4064719.21
14	X=392820.86 Y=4064720.92
15	X=392826.03 Y=4064721.66
16	X=392829.95 Y=4064721.62
17	X=392833.56 Y=4064720.08
18	X=392834.95 Y=4064717.49
19	X=392835.35 Y=4064714.58
20	X=392835.14 Y=4064684.79
21	X=392835.31 Y=4064678.76
22	X=392835.75 Y=4064672.74
23	X=392836.38 Y=4064668.07
24	X=392837.22 Y=4064663.42
25	X=392840.32 Y=4064650.18
26	X=392843.14 Y=4064638.14
27	X=392846.56 Y=4064623.18
28	X=392833.41 Y=4064621.42

SUPERFICIE APROPIABLE PARCELA 16
2.999,53 M2

SUPERFICIE PARCELA 16
3.110,58 M2

SERVIDUMBRE PARCELA 16

1	X=392815.65 Y=4064618.95
2	X=392810.26 Y=4064642.36
3	X=392807.89 Y=4064652.57
4	X=392806.47 Y=4064659.39
5	X=392805.44 Y=4064665.70
6	X=392804.83 Y=4064672.07
7	X=392804.69 Y=4064687.26
8	X=392804.84 Y=4064695.07
9	X=392805.51 Y=4064700.57
10	X=392807.31 Y=4064705.81
11	X=392809.66 Y=4064711.16
12	X=392812.74 Y=4064716.14
13	X=392816.40 Y=4064719.21
14	X=392820.86 Y=4064720.92
15	X=392826.03 Y=4064721.66
16	X=392829.95 Y=4064721.62
17	X=392833.56 Y=4064720.08
18	X=392834.95 Y=4064717.49
19	X=392835.35 Y=4064714.58
20	X=392835.14 Y=4064684.79
21	X=392835.31 Y=4064678.76
22	X=392835.75 Y=4064672.74
23	X=392836.38 Y=4064668.07
24	X=392837.22 Y=4064663.42
25	X=392840.32 Y=4064650.18
26	X=392843.14 Y=4064638.14
27	X=392846.56 Y=4064623.18
55	X=392847.06 Y=4064623.24
54	X=392843.62 Y=4064638.25
53	X=392840.80 Y=4064650.29
52	X=392837.70 Y=4064663.53
51	X=392836.87 Y=4064668.15
50	X=392836.25 Y=4064672.80
49	X=392835.81 Y=4064678.79
48	X=392835.64 Y=4064684.79
47	X=392835.85 Y=4064714.57
46	X=392835.41 Y=4064717.68
45	X=392833.90 Y=4064720.45
44	X=392830.10 Y=4064722.10
43	X=392825.95 Y=4064722.15
42	X=392820.78 Y=4064721.42
41	X=392816.15 Y=4064719.64
40	X=392812.34 Y=4064716.45
39	X=392809.23 Y=4064711.42
38	X=392806.84 Y=4064706.00
37	X=392805.04 Y=4064700.77
36	X=392804.35 Y=4064695.29
35	X=392804.19 Y=4064687.27
34	X=392804.33 Y=4064672.04
33	X=392804.95 Y=4064665.64
32	X=392805.98 Y=4064659.29
31	X=392807.40 Y=4064652.46
30	X=392809.77 Y=4064642.25
29	X=392815.16 Y=4064618.88

SERVIDUMBRE PARCELA 16
111,05 M2

MODIFICACIÓN DEL PROYECTO DE REPARCELACIÓN DEL EXPEDIENTE DE ADAPTACIÓN DEL PLAN PARCIAL DEL SECTOR SUP-B5 (RT) "LAS BIZNAGAS", BENAJARAFE. VÉLEZ MÁLAGA

PLANO DE:	FECHA:	ESCALA:	PLANO N°:
DELIMITACIÓN PARCELAS UAD-1 15 Y 16		Octubre 2022	1 : 400 14
Encarga:			
EXCMO. AYTO VÉLEZ-MÁLAGA			
Arquitecto:			
PABLO JOSÉ ATIENZA JIMÉNEZ			

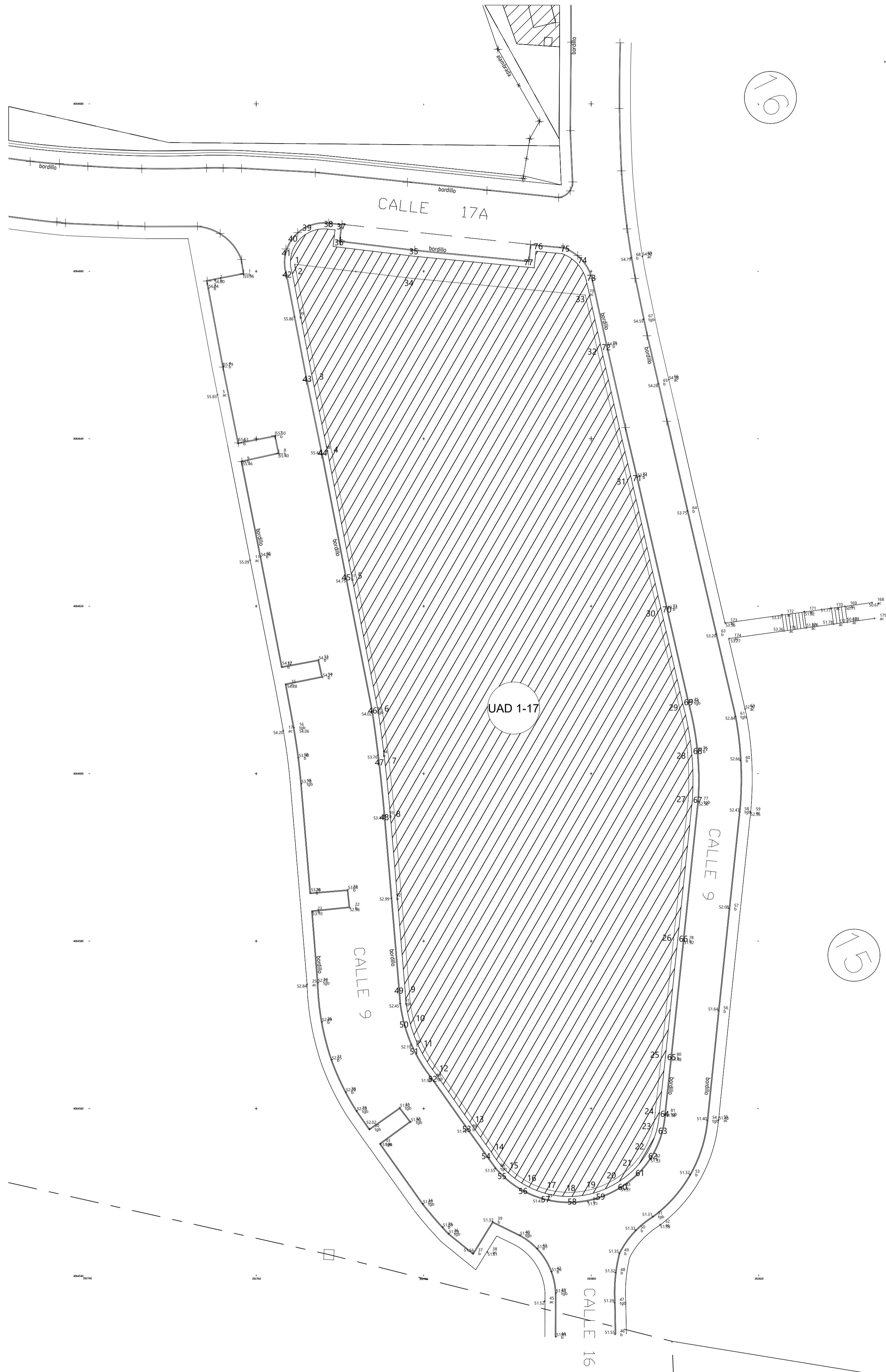

16

15

SERVIDUMBRE PARCELA 17

1	X=392764.60 Y=4064660.85
2	X=392764.80 Y=4064659.88
3	X=392767.24 Y=4064647.18
4	X=392769.05 Y=4064638.37
5	X=392771.94 Y=4064623.48
6	X=392775.05 Y=4064607.59
7	X=392775.88 Y=4064601.34
8	X=392776.52 Y=4064595.08
9	X=392778.29 Y=4064574.04
10	X=392778.83 Y=4064570.46
11	X=392780.01 Y=4064567.32
12	X=392781.91 Y=4064564.35
13	X=392786.22 Y=4064558.25
14	X=392788.56 Y=4064554.97
15	X=392790.38 Y=4064552.74
16	X=392792.56 Y=4064551.19
17	X=392795.01 Y=4064550.27
18	X=392797.69 Y=4064550.00
19	X=392800.42 Y=4064550.46
20	X=392802.88 Y=4064551.61
21	X=392804.87 Y=4064553.19
22	X=392806.36 Y=4064555.17
23	X=392807.34 Y=4064557.59
24	X=392807.64 Y=4064559.51
25	X=392808.37 Y=4064566.23
26	X=392809.83 Y=4064580.18
27	X=392811.57 Y=4064596.77
28	X=392811.50 Y=4064602.52
29	X=392810.46 Y=4064608.18
30	X=392807.90 Y=4064619.38
31	X=392804.31 Y=4064635.13
32	X=392800.72 Y=4064650.70
33	X=392799.29 Y=4064657.16
34	X=392778.57 Y=4064659.16
35	X=392778.86 Y=4064661.80
36	X=392769.18 Y=4064662.97
37	X=392769.42 Y=4064664.94
38	X=392768.58 Y=4064665.04
39	X=392766.45 Y=4064664.71
40	X=392764.99 Y=4064663.58
41	X=392764.25 Y=4064662.16
42	X=392764.31 Y=4064659.75
43	X=392766.74 Y=4064647.09
44	X=392768.56 Y=4064638.27
45	X=392771.45 Y=4064623.38
46	X=392774.56 Y=4064607.50
47	X=392775.39 Y=4064601.28
48	X=392776.02 Y=4064595.03
49	X=392777.79 Y=4064574.00
50	X=392778.34 Y=4064570.36
51	X=392779.50 Y=4064567.23
52	X=392781.51 Y=4064564.05
53	X=392785.81 Y=4064557.96
54	X=392788.15 Y=4064554.70
55	X=392789.98 Y=4064552.43
56	X=392792.30 Y=4064550.76
57	X=392794.90 Y=4064549.78
58	X=392797.73 Y=4064549.50
59	X=392800.66 Y=4064550.02
60	X=392803.14 Y=4064551.18
61	X=392805.19 Y=4064552.80
62	X=392806.67 Y=4064554.71
63	X=392807.81 Y=4064557.41
64	X=392808.14 Y=4064559.47
65	X=392808.87 Y=4064566.18
66	X=392810.33 Y=4064580.13
67	X=392812.07 Y=4064596.73
68	X=392812.00 Y=4064602.56
69	X=392810.95 Y=4064608.30
70	X=392808.39 Y=4064619.49
71	X=392804.79 Y=4064635.24
72	X=392801.21 Y=4064650.81
73	X=392799.41 Y=4064658.94
74	X=392798.35 Y=4064660.90
75	X=392796.48 Y=4064662.11
76	X=392793.41 Y=4064662.39
77	X=392793.19 Y=4064660.41

SERVIDUMBRE PARCELA 17
228,03 M2

APROPIABLE PARCELA 17

1	X=392764.60 Y=4064660.85
2	X=392764.80 Y=4064659.88
3	X=392767.24 Y=4064647.18
4	X=392769.05 Y=4064638.37
5	X=392771.94 Y=4064623.48
6	X=392775.05 Y=4064607.59
7	X=392775.88 Y=4064601.34
8	X=392776.52 Y=4064595.08
9	X=392778.29 Y=4064574.04
10	X=392778.83 Y=4064570.46
11	X=392780.01 Y=4064567.32
12	X=392781.91 Y=4064564.35
13	X=392786.22 Y=4064558.25
14	X=392788.56 Y=4064554.97
15	X=392790.38 Y=4064552.74
16	X=392792.56 Y=4064551.19
17	X=392795.01 Y=4064550.27
18	X=392797.69 Y=4064550.00
19	X=392800.42 Y=4064550.46
20	X=392802.88 Y=4064551.61
21	X=392804.87 Y=4064553.19
22	X=392806.36 Y=4064555.17
23	X=392807.34 Y=4064557.59
24	X=392807.64 Y=4064559.51
25	X=392808.37 Y=4064566.23
26	X=392809.83 Y=4064580.18
27	X=392811.57 Y=4064596.77
28	X=392811.50 Y=4064602.52
29	X=392810.46 Y=4064608.18
30	X=392807.90 Y=4064619.38
31	X=392804.31 Y=4064635.13
32	X=392800.72 Y=4064650.70
33	X=392799.29 Y=4064657.16
34	X=392778.57 Y=4064659.16

SUPERFICIE APROPIABLE PARCELA 17
3.471,56 M2

SUPERFICIE PARCELA 17
3.699,59 M2

MODIFICACIÓN DEL PROYECTO DE REPARCELACIÓN DEL EXPEDIENTE DE ADAPTACIÓN DEL PLAN PARCIAL DEL SECTOR SUP-B5 (RT) "LAS BIZNAGAS", BENAJARAFE. VÉLEZ MÁLAGA

PLANO DE:	FECHA:	ESCALA:	PLANO N°:
DELIMITACIÓN PARCELAS UAD 1-17	Octubre 2022	1 : 300	15
Encargado:			
EXCMO. AYTO VÉLEZ-MÁLAGA			
Arquitecto:			
PABLO JOSÉ ATIENZA JIMÉNEZ			